

# EON-ID™

## QUICK REFERENCE GUIDE

### Getting Started

- 1. Connect BNC Coaxial Cable to Eon-ID™**  
Slide coaxial connector onto BNC.

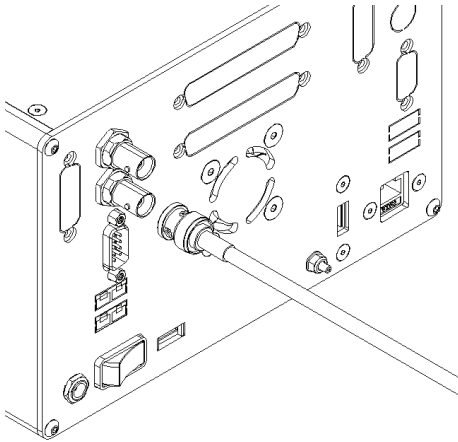

- 2. Connect SMA Coaxial Cable to QCM**  
Spin cable in place using cable shaft until resistance is felt. (Twisting cable shaft past point of resistance may damage cable). Roll fingertip over connector to tighten.

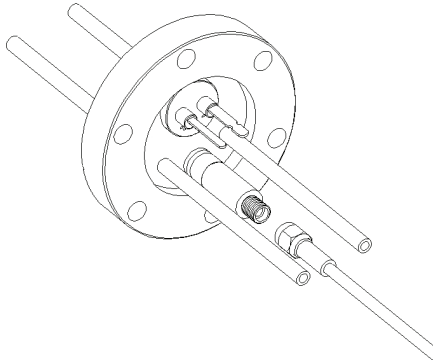

- 3. Attach Eon-ID™ and Sensor to Oscillator**  
Attach Eon-ID™ BNC cable to connector marked "Eon". Then, attach sensor BNC cable to oscillator connector marked "Crystal".

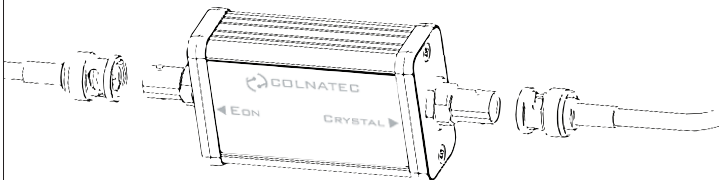

- 4. Connect TC to Eon-ID™**  
Plug thermocouple connector into Eon-ID™.  
*(Disregard if using non-Colnatec-brand sensor)*

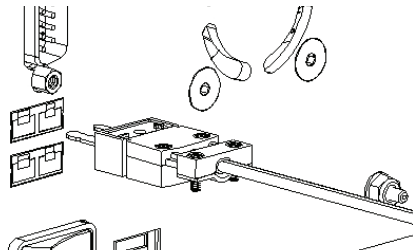

- 5. Connect Power to Eon-ID™**  
Plug Eon-ID™ power adapter into AC outlet. Then plug DC connector into the Eon-ID™.

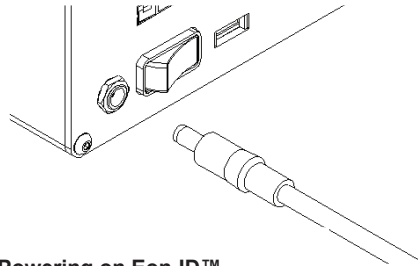

- 6. Powering on Eon-ID™**  
Flip the master power switch on the back of Eon-ID™ to power on unit.

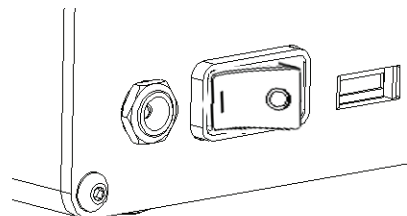

- 7. Software Launches Automatically**  
Once powered up, Eon-ID™ automatically launches Eon™ software.

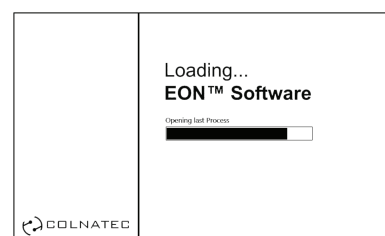

# EON-ID™

## QUICK REFERENCE GUIDE

### Eon-ID™ at a Glance

#### Eon-ID™ Front

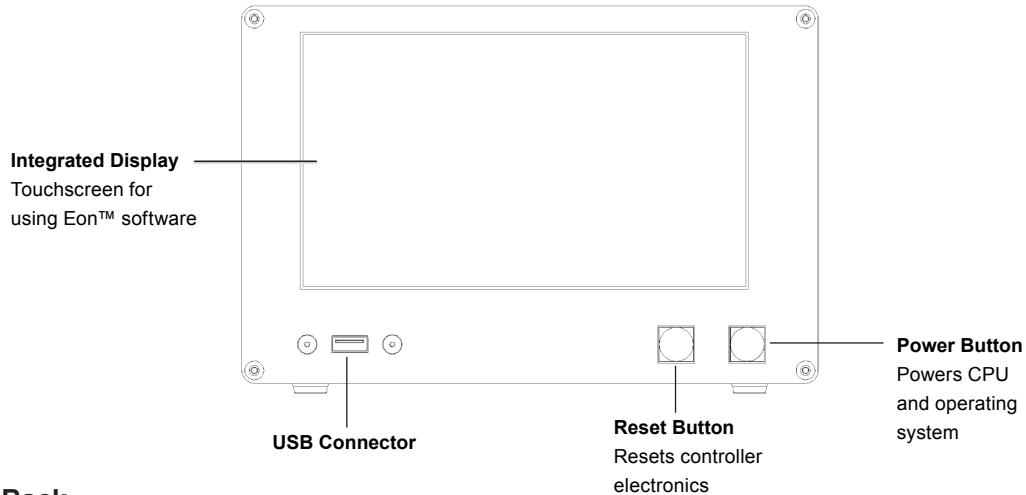

#### Eon-ID™ Back

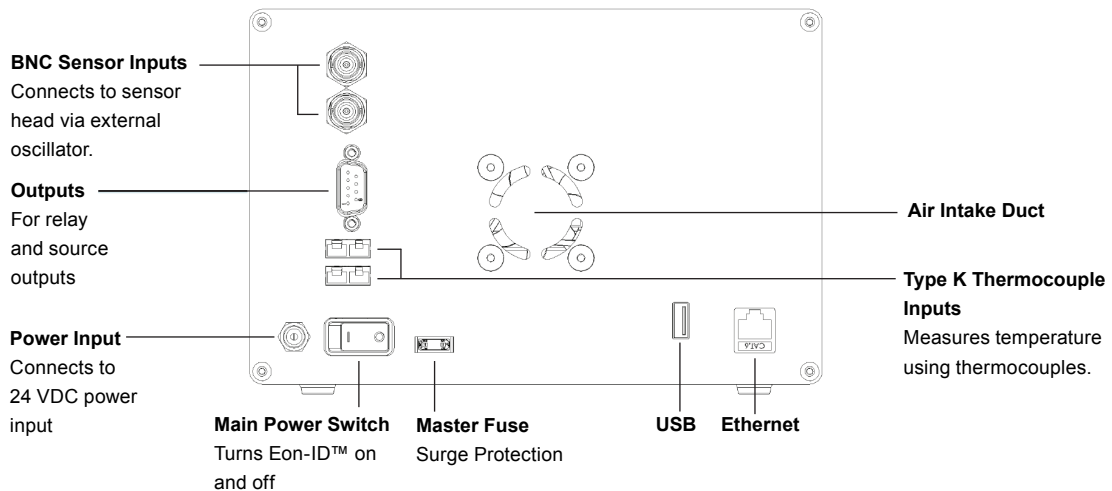

To avoid erratic noise levels in oscillation reading, length between the sensor crystal compartment and the oscillator SHOULD NOT exceed 36 inches (914 mm).

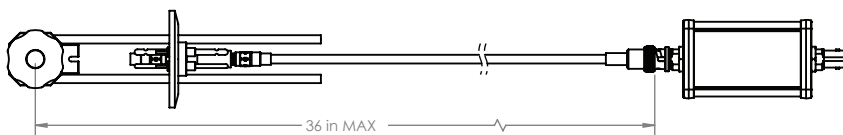

**INSPECT PRODUCT CONDITION ON ARRIVAL**  
Examine Your new Eon-ID™ for any signs of physical damage. Before shipping, your Eon-ID™ was calibrated and tested by Colnatec to meet the highest quality standards.

